



## Information & Instruction Manual

THE ULTIMATE SNOWBIKE EXPERIENCE!



INTRODUCTION

ASSEMBLY

LET'S GO!

MAINTENANCE

WARRANTY & SERVICE

[www.snike.eu](http://www.snike.eu)

[info@snike.eu](mailto:info@snike.eu)



Ros Holding BV  
Lindengarde 51  
2742 TN Waddinxveen  
Netherlands

Rabobank account:  
1473.452.163  
K.v.K Rotterdam  
24406577  
VAT  
NL8174.22.146.B01

Contact  
0031 182 619234  
0031 6 11 52 00 92  
0031 6 22 22 82 52  
[info@snike.eu](mailto:info@snike.eu)

Internet  
[www.snike.eu](http://www.snike.eu)

## THE ULTIMATE SNOWBIKE EXPERIENCE!

This Information & Instruction Manual will provide you with practically everything you need to know about your Snike. Please read this manual carefully, as it contains essential information about safely operating your Snike, and keeping it in optimal condition.

### DID YOU KNOW THAT?

- Your Snike is produced using corrosive-resistant materials and production takes place in a non-ferro environment? This ensures pure and strong welds and prevents rust.
- A weekly check takes only 5 minutes, and a pre-ride check even less.
- There is no reason to pay any bills for maintenance, unless you don't know the difference between a screwdriver and a hammer.

### READ ABOUT THIS, AND MORE, IN THIS INFORMATION & INSTRUCTION MANUAL

The Assembly section describes how your Snike is put together.

The "Let's Go!" section provides practical information about using your Snike on the slopes.

The Maintenance section provides instructions for keeping your Snike in shape.

Warranty and Service provides information about your warranty, and how you can get Snike back in shape.

• INTRODUCTION

ASSEMBLY

LET'S GO!

MAINTENANCE

WARRANTY & SERVICE

[www.snike.eu](http://www.snike.eu)

[info@snike.eu](mailto:info@snike.eu)

**SNIKE**®

## ASSEMBLY

Every Snike has been accurately preassembled and checked by the Snike team before delivery. This section of the manual will provide you with basic assembly instructions, allowing you to prepare your Snike for downhill fun, or easy transport.

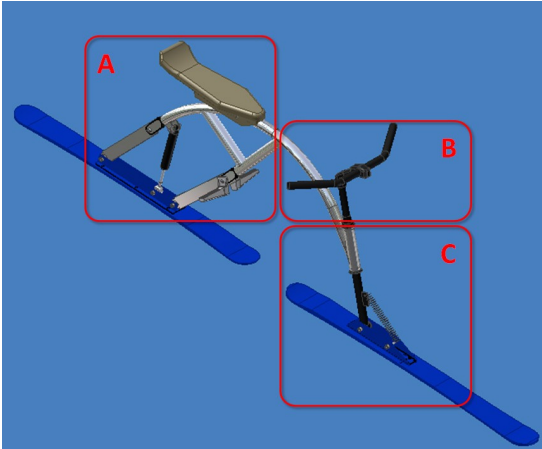

Assembly instructions are divided into three main areas:

- A: Rear assembly
- B: Steering assembly
- C: Front Assembly

### A: REAR ASSEMBLY

For easy transport or access to small lift cabins, the rear ski can be folded forward. This greatly shortens the length of your Snike, without having to use any tools.

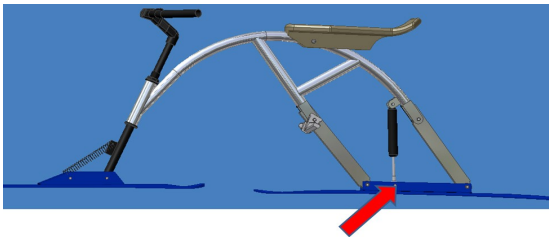

Step 1: Release the quick release, located at the point where the rear suspension is connected to the rear ski binding.

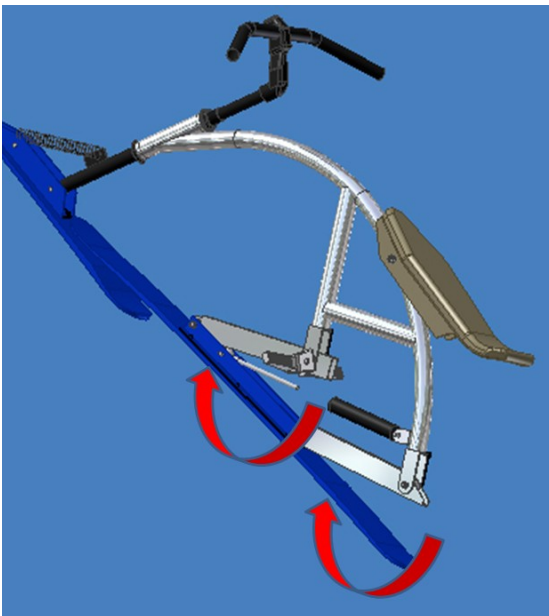

Step 2: Push rear ski forward.

## INTRODUCTION

- **ASSEMBLY**

### LET'S GO!

### MAINTENANCE

### WARRANTY & SERVICE

[www.snike.eu](http://www.snike.eu)

[info@snike.eu](mailto:info@snike.eu)

**SNIKE**®

## INTRODUCTION

- ASSEMBLY

## LET'S GO!

## MAINTENANCE

## WARRANTY & SERVICE

[www.snike.eu](http://www.snike.eu)

[info@snike.eu](mailto:info@snike.eu)

**SNIKE®**

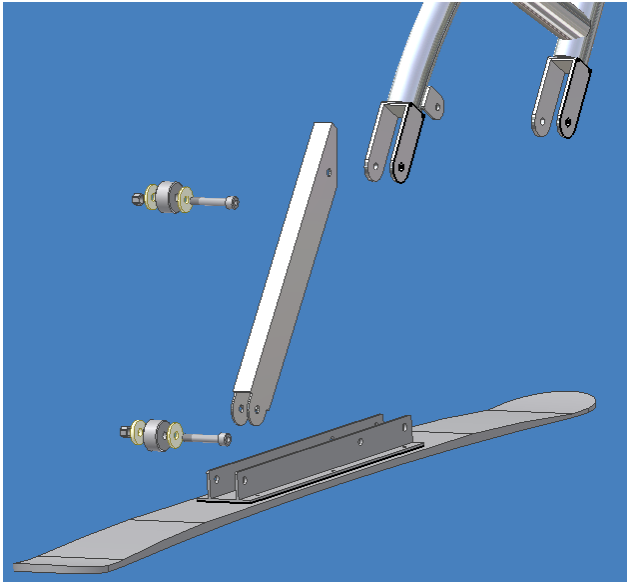

Assembly of rear suspension arms as illustrated. Please ensure that the rear-rear suspension arm is positioned as illustrated.

For assembly, a 13mm spanner in combination with 8mm hex key is required.

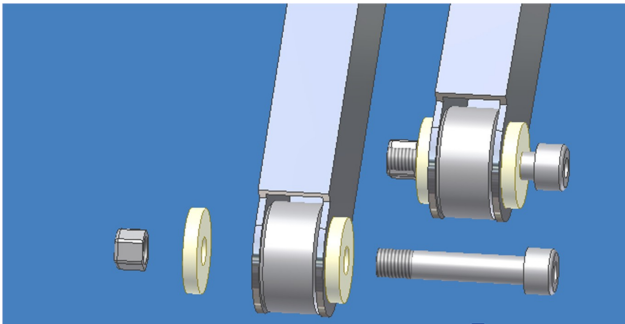

Slide the big spacer into the suspension arm. Place the nylon rings on either side and insert into the rear binding. Apply a small amount of lock-tight to the inside tread of the lock-nut. This will prevent vibrations loosening the assembly during operating. Using the spanner and hex key, tighten the lock-nut onto the bolt. Make sure the lock-nut is tightened up to the point where significant friction is achieved in the joint, but movement is still possible relatively easily. Repeat installation for front-rear suspension arm, as well as connecting these arms to the main frame. For easy installation, place complete assembly on its side.

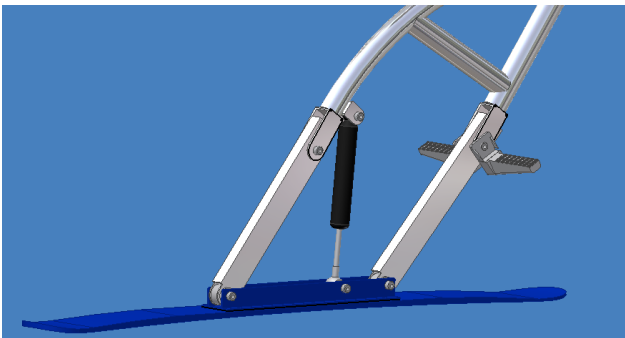

Install rear spring/shock as illustrated.

## B: STEERING ASSEMBLY

### ALIGNING THE STEERING ASSEMBLY:

Locate the hex nut on top of the steering assembly (location indicated by red arrow). Turning this clockwise will tighten the nut, anti clockwise will loosen the nut. For adjustment, first loosen the nut. Move the steering assembly to the correct position, ensuring proper alignment with the front ski. After correct alignment is achieved, tighten this nut well.

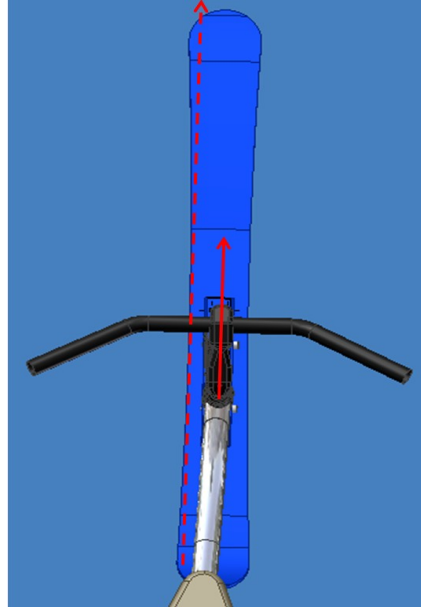
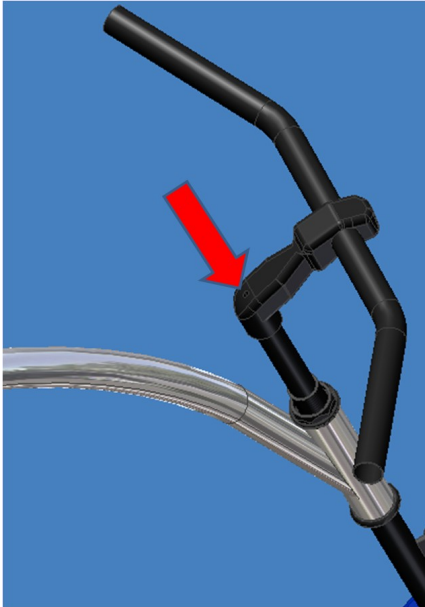

### REMOVING THE STEERING ASSEMBLY OR PREPARING FOR TRANSPORT:

Locate the hex nut on top of the steering assembly (location indicated by red arrow). Turning this clockwise will tighten the nut, anti clockwise will loosen the nut. For adjustment, first loosen the nut. Move the steering assembly 90 degrees to the left (or right), and tighten the nut slightly. Moving the handlebars in this position allows for easier transport or efficient storage.

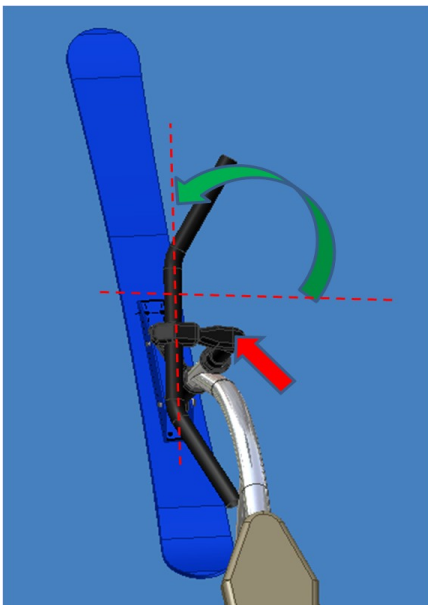

## INTRODUCTION

### • ASSEMBLY

### LET'S GO!

### MAINTENANCE

### WARRANTY & SERVICE

[www.snike.eu](http://www.snike.eu)

[info@snike.eu](mailto:info@snike.eu)

**SNIKE**®

## C: FRONT ASSEMBLY

The front steering is connected to the frame using a double bearing assembly. This allows for light steering without any free-play in the assembly. Periodic adjustment may be required.

Adjustment requires the following steps:

Loosen nut "C" by turning it anti-clockwise.

Bearing 'B' threads onto the steering rod. Tighten this bearing by hand, up to the point where all free-play is removed. Please make sure that this bearing is not too tight, as this could damage the bearing.

After correctly positioning bearing 'B', re-lock it in place by threading nut 'C' onto the rod. Ensure that bearing 'B' does not move when it is locked in place by nut 'C'.

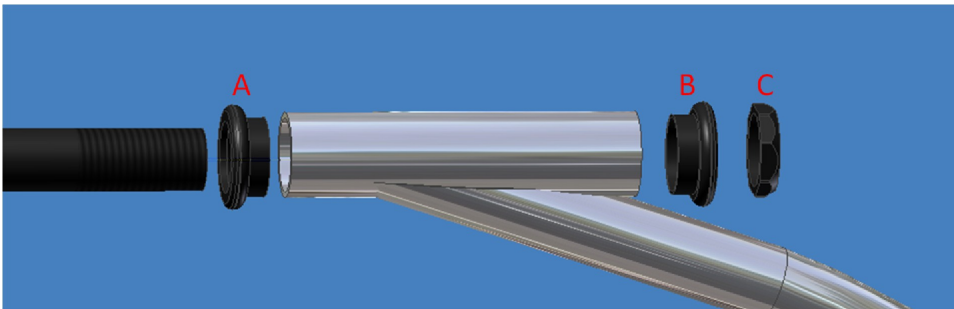

## INTRODUCTION

### • ASSEMBLY

### LET'S GO!

### MAINTENANCE

### WARRANTY & SERVICE

[www.snike.eu](http://www.snike.eu)

[info@snike.eu](mailto:info@snike.eu)

















**SNIKE**®



## LET'S GO!



### PLANNING YOUR ROUTE

Depending on your level of experience, please make sure that you plan your route carefully. Proper planning will prevent you from being forced down slopes which are too challenging for you and will prevent you from ending up at points where ski-lifts are not compatible with the Snike.

Slope type	Beginner	Medium	Expert
 Green			
 Blue			
 Red			
 Black			

 Suitable    
  Challenging    
  Not recommended

### PLEASE FOLLOW THESE GUIDELINES TO PREVENT UNCOMFORTABLE SITUATIONS:

Some lift types are more suitable than others:



When using small lift cabins, take Snike with you into the cabin! Most cabins will require you to fold your rear-ski inward. For an optimal fit, you can also change the position of the handle bars. Do this well in advance.



Chairlifts are comfortable, but make sure that you position yourself on the far left or right side of the row of seats. Hold the snike next to the row of seats, until the protective bar is pulled down. As soon as this bar is in place, hook the Snike onto this bar, and enjoy the ride. Just before leaving the chairlift, unhook Snike from the seats and position it next to the seats. Some practice may be required, and do signal the lift operator to slow down to prevent uncomfortable situations.



Gondola's are well suited for transporting Snike. For easy entry and exit, folding the rear-ski inward is recommended.



Drag lifts are not suited for your Snike. Avoid these or use the adaptor.

## INTRODUCTION

### ASSEMBLY

- LET'S GO!

### MAINTENANCE

### WARRANTY & SERVICE

[www.snike.eu](http://www.snike.eu)

[info@snike.eu](mailto:info@snike.eu)

**SNIKE**®



## MAINTENANCE

Snike is designed to keep maintenance to an absolute minimum. To ensure continued safe operations, we recommend the following inspection and maintenance guidelines.

### PRE RIDE CHECK, DAILY ( 1 MINUTE)

Before creating your ultimate snowbike experience, be sure to check the following:

- 1) Visually inspect that all nuts and bolts are where they should be.
- 2) Ensure that the rear shock quick release is connected properly.
- 3) Check that the handle bars are aligned properly, and fastened tightly.
- 4) Inspect the underside of the ski's, for damage.

### WEEKLY CHECK (5 MINUTES)

After a week of intensive downhill fun, be sure to check the following:

- 1) Ensure that the screws connecting the bindings to the ski's are tight.
- 2) Ensure that all nuts are securely in place. Apply a small amount of lock-tight into the thread of the lock-nut, when it is re-installed or adjusted.

### ONCE A YEAR (30 MINUTES)

- 1) Inspect the underside of the ski's, and have these serviced by a qualified ski shop in case of damage or dull edges.
- 2) Carefully disassemble the rear suspension components and inspect these for damage or excessive wear. Re-assemble, making sure all components are clean.
- 3) Disassemble the front steering rod and bearings. Make sure that no dirt gets into the bearings, and wipe off old grease with a rag carefully. Inspect for abnormal wear. Apply small amount of fresh grease to the bearings and reassemble.

## STORAGE

Even though your Snike is produced using corrosive resistant materials and production processes, prolonged exposure to extreme conditions is not recommended. Prolong your Snike's lifespan by following three basic rules:

Keep It dry

Keep it clean

Avoid contact between the ski's and other abrasive surfaces (such as garage floors!)

## CLEANING

Use warm water and a soft sponge to clean your snike. Mild detergent may be used. Dry off the frame with a piece of cloth.

Do not use:

- Abrasive cleaning systems, such as scotch pads
- Chemical cleaners
- High pressured water
- Polishing agents

## INTRODUCTION

## ASSEMBLY

## LET'S GO!

- **MAINTENANCE**

## WARRANTY & SERVICE

[www.snike.eu](http://www.snike.eu)

[info@snike.eu](mailto:info@snike.eu)

**SNIKE**®

## WARRENTY & SERVICE

We take great pride in our product and care about your satisfaction. Warranty is offered on your Snike as summarized below:

- 1st Buyer Lifetime warranty on your Snike frame
- 2 year warranty on all additional components
- 1 year warranty on the ski's

This warranty covers all component failures. Naturally, the warranty excludes negligence or extreme impact damage. Please check our website for instructions about what to do in the unlikely event of problems with your Snike.

**INTRODUCTION**

**ASSEMBLY**

**LET'S GO!**

**MAINTENANCE**

- **WARRENTY &  
SERVICE**

[www.snike.eu](http://www.snike.eu)

[info@snike.eu](mailto:info@snike.eu)

**SNIKE**®